



Quality First For Performance That Lasts

## CVC600HC Series Quick Installation Guide

### Included in the box:

- 1 - CVC600HC Series - Camera
- 1 - Mounting Bracket Kit
- 1 - Mounting Bolt Set

**! Please include this Quick Installation Guide with the other vehicle documentation provided to the end user.**

**1** Determine a secure and suitable mounting location for your camera. The camera should be installed so that the area you are trying to view is clearly seen on the display and a critical reference (leading edge) of the vehicle is also visible. For example: Rear mounted cameras should be installed to give you the maximum viewing area behind the vehicle while still seeing the rear most part of the vehicle, typically the rear bumper, or the leading edge at the bottom of the displayed image.

**2** Install the camera bracket and gasket with the hardware provided. The gasket is placed between the camera bracket and vehicle surface. Use the bracket as a template for drilling the required holes. The recommended mounting bolt torque specification is between 20 and 22 inch pounds.

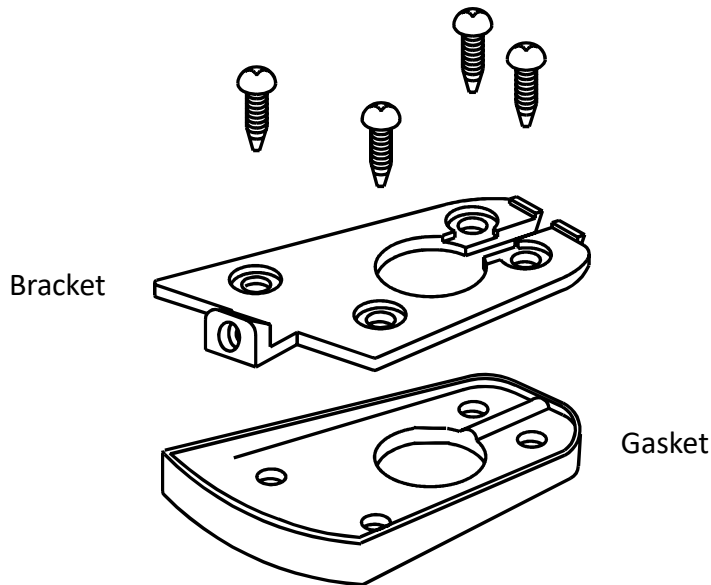

### ⚠ WARNING

Use only INTEC supplied camera brackets. The INTEC camera bracket provides the necessary required isolation from the vehicle body. Failure to do so could result in a fire if shorting occurs.

### ⚠ CAUTION

Be certain that all items are secure. Items that are not secure or mounted in an unstable manner can come loose and cause damage or personal injury.

Do NOT install the camera in any area that allows it to extend out past the vehicle, as this can cause injury if it were to come in contact with people walking around the vehicle.

Always verify the area being drilled into is of sufficient strength and is clear of all wires and other items around or underneath so as not to cause damage.

Always confirm proper image orientation before driving or operating your vehicle. The orientation of the image displayed is critical to safe vehicle operation. An object on the right side of your vehicle needs to be seen on the right side of the display screen.

Before you begin driving, be sure the display controls are adjusted properly. This will avoid unnecessary distractions while driving.

For more detailed installation instructions, please visit [www.intecvideo.com/support.html](http://www.intecvideo.com/support.html)  
You may also call us toll free at 800-468-3254 (West) or 800-522-5989 (East) or e-mail [support@intecvideo.com](mailto:support@intecvideo.com) with any questions. Rev A 05/2019

**3** Connect the camera to the main cable by aligning the keys and pushing together until firmly seated.

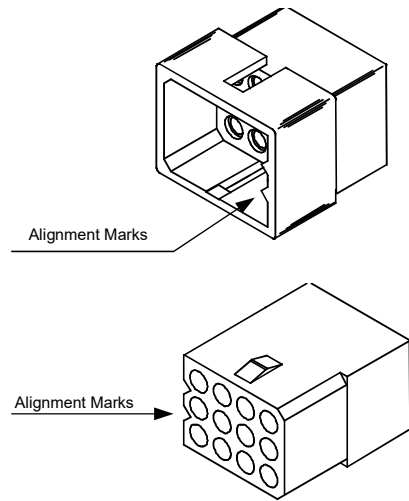

**Note:** The Molex connection is not waterproof and should not be exposed to the environment. It is recommended that the connection be made inside the vehicle's body.

If exposed to the environment, the Molex connectors must be weatherproofed. A simple means is to use 1-inch diameter gum interior heat shrink tubing (INTEC part # CVST10) to cover the whole connector assembly. This will seal and protect the connector from direct moisture due to rain, snow, vehicle washing, etc.

**4** Assemble the camera to the bracket.

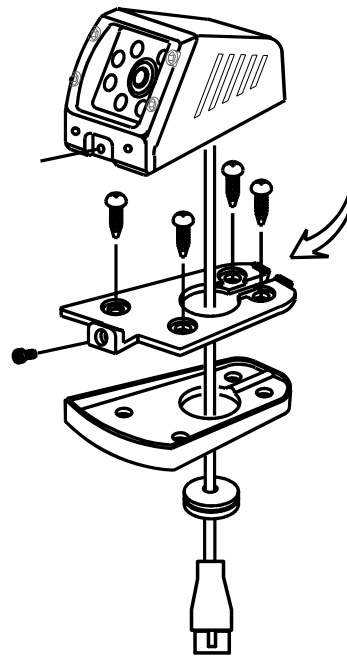

**Installation Option:** Some installation may require routing the cable along the vehicle body. If this becomes necessary cut the gasket as shown below allowing the cable to exit the rear of the camera enclosure.

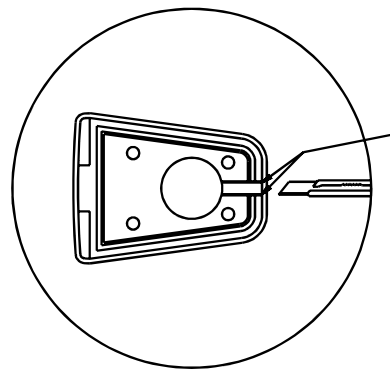

**Changing the Camera Image:** Some monitors like INTEC's CVMHDVR706 allow for image rotation via the monitor's software in either the vertical or horizontal plain or both. However other monitors do not have this capability. If you need to change the camera image at the camera, you can do so by using a flat screwdriver. Remove the screw from its current position and place it in the opposite one. Refer to the camera enclosure bottom diagram below.

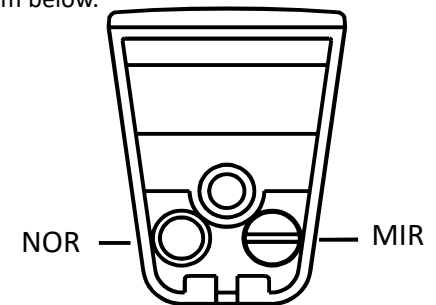

**Mounting Options:** In addition to the typical rear camera mount there are four side and two ceiling mounting options. They include the:

- CVC600HCS-1 left front viewing rearward
- CVC600HCS-2 right front viewing rearward
- CVC600HCS-3 right rear viewing forward
- CVC600HCS-4 left rear viewing forward
- CVC600HCC-1 ceiling front viewing rearward
- CVC600HCC-2 ceiling rear viewing forward

